

SPECIFICATIONS

Model No.	CK-LAQ08
Capacity	0.8 liter
Rating	AC 220-230 V 50/60 Hz
Electric Consumption	1006-1100 W
Length of Power Cord	0.7 m
External Dimensions (approx. cm)	28 (W) x 16 (D) x 21 (H) (Not including the Power Base)
	28 (W) x 16 (D) x 23 (H)
Weight	Approx. 1.0 kg (Not including the Power Base)
	Approx. 1.3 kg

- In high altitudes or severely cold areas, the product may not perform as specified. Avoid using the product in such areas or in other extreme conditions.
- This product is not suitable for use in countries or regions with different power supply voltages or frequencies.

How to change the Fuse

1. Open the Fuse Cover of the Power Plug.
2. Remove the Fuse installed inside.
3. Install a new Fuse on the Fuse Cover and fit back it to the Power Plug.
(Be sure to replace with a Fuse of the same current value as the installed Fuse.)

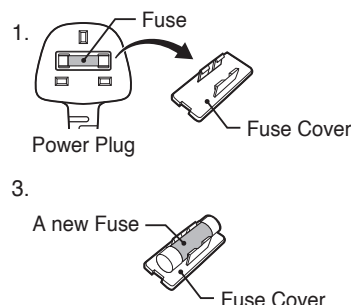

HKG

SGP

ELECTRIC KETTLE OPERATING INSTRUCTIONS

CK-LAQ08

- Always follow basic safety precautions when using electrical appliances.
- Read all instructions carefully. Please keep these Operating Instructions at hand for easy reference.

INDEX

BEFORE USE

IMPORTANT SAFEGUARDS2
PART NAMES AND FUNCTIONS6

HOW TO USE

HOW TO USE9
EMPTY BOILING DETECTOR11

CLEANING AND MAINTENANCE

CLEANING AND MAINTENANCE ...11
HOW TO PERFORM CITRIC ACID CLEANING ...12
HOW TO REPLACE THE INNER LID GASKET ...13
REPLACEMENT PARTS13

BEFORE CALLING FOR SERVICE

TROUBLESHOOTING GUIDE14
SPECIFICATIONS16

- This product is for boiling water only and does not have a Keep Warm function.
- This product does not have a mechanism for locking the pouring of hot water.

ZOJIRUSHI CORPORATION
OSAKA, JAPAN



IMPORTANT SAFEGUARDS Be sure to follow these instructions.

These WARNINGS and CAUTIONS are intended to prevent property damage or personal injury to you or others.

■ The degree of danger or damage by the misuse of this product is indicated as follows:

 WARNINGS	Indicates risk of serious injury or death.	 CAUTIONS	Indicates risk of injury, household or property damage if mishandled.
--	--	---	---

■ Prohibited or required actions are indicated as follows:

 Indicates a prohibited operation.	 Indicates a requirement or instruction that must be followed.
--	---

WARNINGS

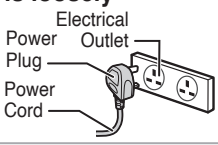
 <p>Do not modify the product. Only a repair technician may disassemble or repair this unit. Attempting to do so may cause fire, electric shock or injury. Make any repair inquiries (excluding the replacement of the Inner Lid Gasket [Expendable Part]) to the retail store where you purchased this product.</p>	<p>Do not use a power source other than 220-230 V AC. Use of any other power supply voltage may cause fire or electric shock.</p>
<p>Do not immerse the product in water or splash it with water, and do not put it on a wet surface such as a sink. Doing so may cause short circuit or electric shock.</p>	<p>Do not use the product if the Power Plug or Power Cord is damaged or if the Power Plug is loosely inserted into the electrical outlet. Doing so may cause electric shock, short circuit or fire.</p> 
<p>Do not plug or unplug the Power Plug if your hands are wet. Doing so may cause electric shock or injury.</p>	<p>Do not damage the Power Cord. Do not bend, pull, twist, fold, or attempt to modify the Power Cord. Do not place it on or near high-temperature surfaces or appliances, under heavy items or between objects. A damaged Power Cord can cause fire or electric shock.</p>
<p>Do not allow liquid to come into contact with the Receptacle or Power Base. Doing so may cause short circuit or electric shock.</p>	<p>Do not place the product over direct flame (such as a gas stove top) or on top of electric or induction heating (IH) cookers. Doing so may cause fire, breakdown of the product.</p>
<p>Do not allow the Receptacle and Connector (metal parts) to become soiled with dust or come into contact with any metal objects. Doing so may cause electric shock, short circuit or fire.</p>	<p>Do not touch the Steam Vent or Spout or bring your hands or face near the Steam Vent or Spout. Doing so may cause burns or scalding. Take special precautions with children and infants.</p>
<p>Do not allow infants or children to lick the Receptacle and Connector (metal parts). Doing so may cause electric shock or injury. Take special precautions with children and infants.</p>	<p>Do not cover the Steam Vent or Spout with anything such as a dishcloth. Hot water may spill out, resulting in scalding. It may also cause deformation or discoloration of the Upper Lid or breakdown of the product.</p>

● The illustrations used in these Operating Instructions may vary from the actual product you have purchased.

WARNINGS



Do not slam the Upper Lid when closing.
Hot water may spill out, resulting in scalding.

Do not tilt or tip over the product.
Hot water may spill from the Spout, resulting in scalding. This product does not have a mechanism for locking the pouring of hot water. Even if the Upper Lid is closed, hot water may spill out from the Spout, for example, depending on the state of the product when it tips over.

Do not tilt the Body excessively when pouring the hot water. Also, only tilt the Body in the direction of the Spout.
Hot water will leak from the Steam Vent or the bottom of the Body, resulting in scalding or electric shock.

Do not tilt or shake the product or carry it in your arms. Do not move it or drain hot water by holding the Upper Lid.
Hot water may spill from the Spout, resulting in scalding. This product does not have a mechanism for locking the pouring of hot water. Hot water will be poured from the Spout as soon as the product is tilted, so handle the product carefully.

Do not use the product as a cooler or place ice inside of it.
Doing so may cause condensation, resulting in electric shock or breakdown of the product.

Do not fill over the Maximum Water Level Line.

Overfilling may cause hot water to spill out, resulting in scalding. In addition, this may cause water droplets to drip from the Spout, the bottom of the Body, or under the Handle.

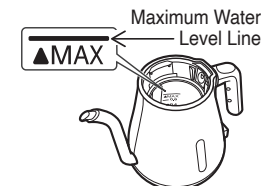

Do not fill with or boil anything other than water.

Attempting to boil, cook, or heat up the following items may cause bubbling or boiling over, which may cause scalding. Doing so may also cause clogging of the water route, or scorching and corrosion of the Inner Container.

- Milk, sake, soup, charcoal, tea bags, tea leaves, coffee grounds, or instant coffee
- Instant food
- Food and sauce pouches or foods in plastic bags
- Water additives such as charcoal for water purification or mineral additives



Use only an electrical outlet rated at 10 amperes minimum, and do not plug other devices into the same outlet.

Plugging other devices into the same outlet may cause the electrical outlet to overheat, resulting in fire.

Insert the Power Plug completely and securely into the electrical outlet.

A loosely inserted Power Plug may cause electric shock, short circuit, smoke or fire.

If the blades (plug tip) or base of the Power Plug become soiled, wipe them clean.

A dirty Power Plug may cause fire.

Make sure to attach the Upper Lid.

Hot water may spill out when the product is overturned, resulting in scalding.

Stop using immediately if you notice any of the following symptoms indicating a malfunction or breakdown.

Continued use of the product may cause smoke, fire, electric shock or injury.

<Examples of Abnormalities and Malfunctions>

- The Power Plug or Power Cord becomes very hot.
- The Power Cord is damaged or the electricity turns on and off when touched.
- The product is deformed or unusually hot.
- Smoke arises from the product or there is a burning smell.
- Some part of the product is cracked, loose or unstable.
- Steam continues to come out of the Steam Vent or Spout for at least 5 minutes.
- Water leaks from the product.

If any of the above occurs, unplug the Power Plug immediately and return to the retail store where you purchased this product for check-ups and/or repairs.

IMPORTANT SAFEGUARDS (cont.)

⚠ WARNINGS



Replace the Inner Lid Gasket if it hardens, changes shape, turns white, or otherwise becomes worn out.

Hot water may spill out when the product is tilted or tipped over accidentally, and may cause scalding. Steam may also leak out from the gap and cause scalding or breakdown of the product.

This product is not intended for use by persons (including children) with reduced physical, sensory or mental capabilities, or lack of experience and knowledge, unless they have been given supervision or instruction concerning use of the product by a person responsible for their safety. Children should be supervised to ensure that they do not play with the product.

⚠ CAUTIONS



Do not attempt to move the product or pour out hot water during the boiling process.

Doing so may result in hot water spurting out, or in scalding.

Do not detach the Upper Lid while the water is boiling or for a while after the water is finished boiling.

Doing so may result in scalding.

Avoid skin contact with hot surfaces (Receptacle, etc.) while in use or shortly after use.

Contact may result in scalding.

Do not hold or carry the product by the Lid Lock.

The Upper Lid may detach, resulting in injuries or scalding.

Do not apply excessive force to the Nozzle.

Doing so may result in a malfunction or breakdown.

Do not use the product if the tip of the Spout is deformed.

Doing so may result in hot water spurting out or scalding.

Always use caution when detaching the Upper Lid, and avoid skin contact with steam.

Steam may escape upon detaching the Upper Lid and cause scalding.

When discarding hot water, avoid skin contact with steam.

Doing so may result in scalding.

Do not operate the product when it is empty.

Doing so may cause fire or breakdown.

Do not place or use the product on unstable surfaces.

Doing so may cause scalding or injuries.

Do not use the product near a heat source.

This may cause fire, breakdown of the product.

Do not use on surfaces that are sensitive to heat.

Doing so may cause fire.

Do not use the product near walls or furniture.

Steam or heat may damage, discolor or deform walls or furniture.

Do not use the product on top of other electrical appliances.

When there is a water leakage, this may cause fire or breakdown of other electrical appliances.

Do not use the product where steam may come into contact with other electrical appliances.

The steam may cause fire, malfunction, discoloration or deformation of other electrical appliances.

Do not use any Power Base than the one provided.

Do not use the Power Base for other appliances.

Do not use the Power Base for overseas models.

Doing so may cause malfunction or fire.

⚠ CAUTIONS



Allow the product to cool down before cleaning.

Touching hot surfaces may cause burns.

When using continuously, allow the Upper Lid and the Body to cool down before boiling water.

Not doing so may cause burns.

Unplug the Power Plug from the electrical outlet when the product is not in use.

Leaving the Power Plug in an electrical outlet may result in burns, injuries or electric shock from damaged insulation, or fire from a short circuit.

Wait until boiling completes to pour hot water.

Not doing so may result in hot water spurting out, or in scalding.

Always unplug the product by holding the Power Plug, not by pulling the Power Cord.

Pulling the Power Cord to unplug the product may cause electric shock, short circuit or fire.

If the Power Cord is damaged, it must be replaced by an appropriate cord or assembly made available by the manufacturer or its service agent.

IMPORTANT

■ **Allow the Inner Container to dry completely when storing the product for a long period of time where it may freeze.**

If water left inside freezes, it may cause breakdown or malfunction.

■ **Avoid letting steam make contact with cabinets and walls when using near or under a kitchen shelf.**

Steam contact may cause discoloration or deformation.

■ **Do not splash water on the Power Switch.**

Doing so may cause breakdown of the product.

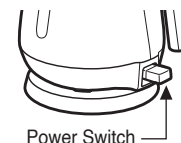

■ **When filling with water and detaching and attaching the Upper Lid, first remove the Body from the Power Base.**

Not doing so may splash water on the Power Base and cause malfunction.

■ **Avoid rough handling, dropping or bumping the product.**

Doing so may cause damage or cease operation of the product.

■ **Do not place the Body or the Power Base too hard, or drag them over any surface while attempting to move.**

Doing so may cause damage to surfaces such as countertops.

■ **Wipe off any remaining water droplets around the edge of the Inner Container.**

This may cause water to drip out from between the Upper Lid and the Body when pouring.

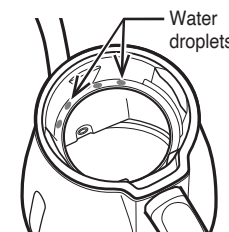

■ **Do not continue to press the Power Switch to force the water to continue boiling.**

Doing so may result in steam accumulating inside the Body, resulting in breakdown, water leakage, or scalding.

■ **Take care to ensure the operation of the Power Switch is not hindered by parts such as the Power Cord.**

The Power Cord or a similar part catching on the Power Switch may prevent the power from turning off automatically, which may result in steam accumulating inside the Body, resulting in breakdown, water leakage, or scalding.

■ **This product is intended to be used in household and similar applications such as;**

- Staff kitchen areas in shops, offices and other working environments
- Environments comparable to residential living rooms and kitchens

* This product is not intended for use by many unspecified people for a long period of time.

Notice

When taking out the product from the box for the first time, the Upper Lid and/or the Inner Container may be wet. This is caused by the boiling test operated before shipment. When using the product for the first time, before use, boil water once and discard it.

PART NAMES AND FUNCTIONS

- This product consists of a separate Body and Power Base.
- This product does not have a mechanism for locking the pouring of hot water. Hot water will be poured from the Spout as soon as the product is tilted, so handle the product carefully.

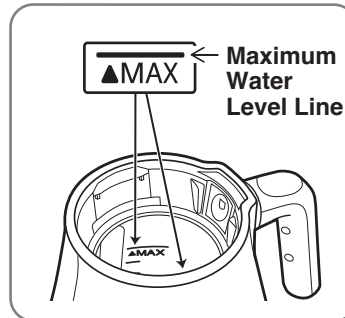
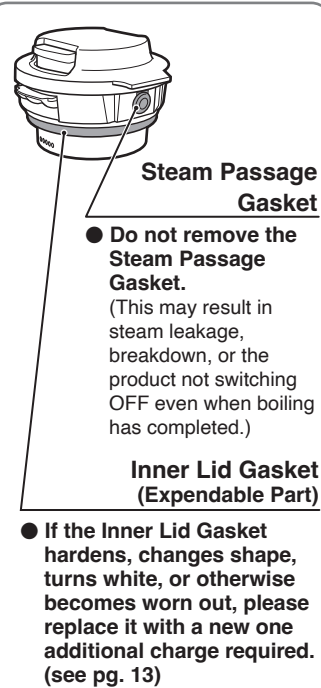
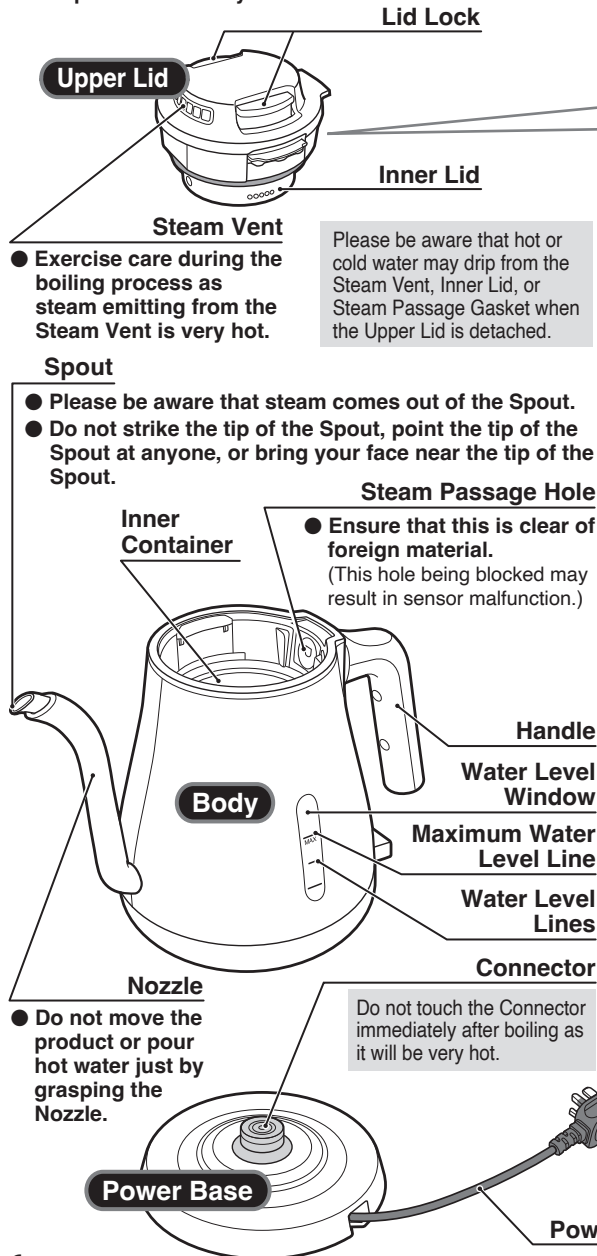

Control Panel

The product is switched ON and the Boil Light turns on when the Power Switch is lowered.

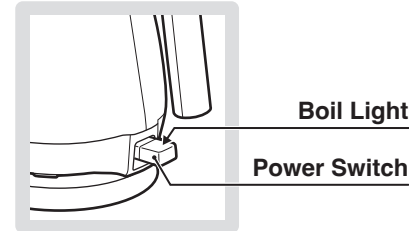

When switched ON

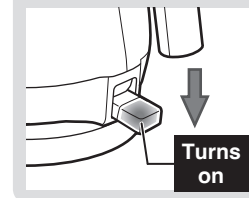

When switched OFF

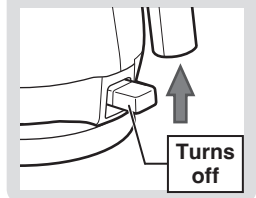

Body Bottom

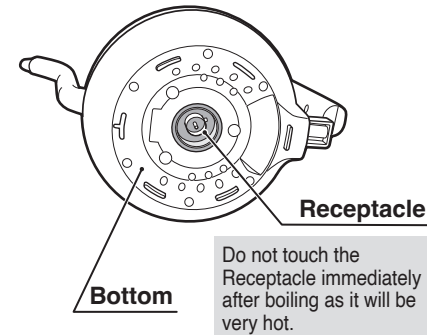

Power Base Bottom

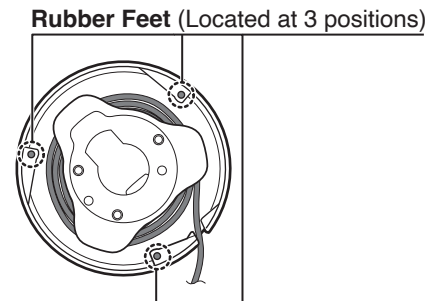

How to Shorten/Lengthen the Power Cord

Adjust the length of the Power Cord by wrapping it clockwise around the bottom of the Power Base, and allow it to come out of the Power Base from the Opening at the bottom.

Power Base Bottom

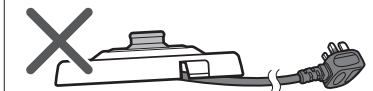
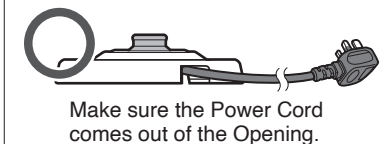
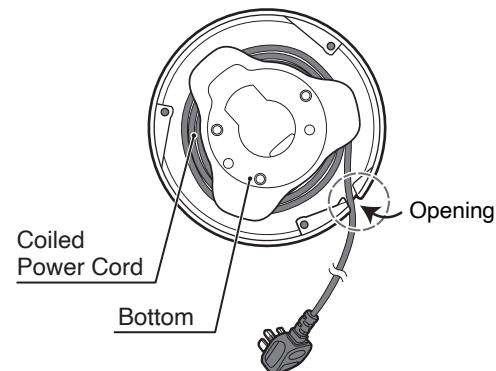

- Do not place the Power Base on top of the Power Cord. (Doing so may cause the product to tilt or tip over. Placing heavy items on the Power Cord or pinching it may damage the Power Cord and cause fire or electric shock.)

PART NAMES AND FUNCTIONS (cont.)

How to Detach/Attach the Upper Lid

● If the product tips over...

- Do not put your hand or other body parts near the Steam Vent or Spout when standing up the product.
(Hot water or steam may come out of the Steam Vent or Spout, resulting in scalding.)
- After standing the product up, detach the Upper Lid and tilt the Upper Lid to pour out the hot water that has accumulated on the inside of it.
(Hot water may accumulate on the inside of the Upper Lid, resulting in scalding.)



To Detach

- 1 Press in the Lid Lock as illustrated.
- 2 Pull up and detach the Upper Lid.

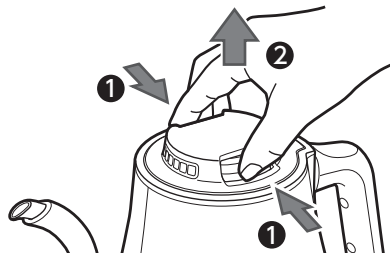

- Hot or cold water that has accumulated on the inside of the Upper Lid may drip from the Steam Vent, Inner Lid, or Steam Passage Gasket. When detaching the Upper Lid, be careful not to get drips from the inside of the Upper Lid on your hands.

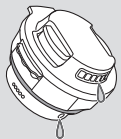

To Attach

- 1 Attach the Upper Lid so its protrusion lines up with the depression on the Handle of the Body.

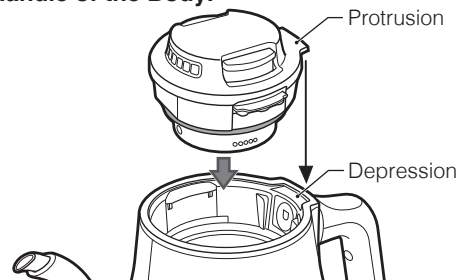

- 2 Push the Upper Lid down securely until it clicks.



- Make sure that the Upper Lid is completely attached.

The Upper Lid is not completely attached if the Upper Lid is tilted or you can see **mark A** or **mark B**. Push the Upper Lid down securely until you can no longer see the **marks (A and B)**. Continued use of the product may cause hot water to spill out, resulting in scalding. The product may not switch OFF even when boiling has completed, resulting in breakdown.

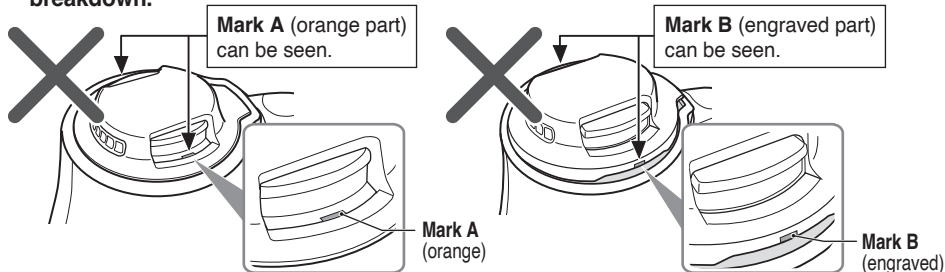

Be careful not to let the product tip over.

HOW TO USE

- The first time you use the product or after storing it for a long period of time, boil water once and discard it from the Spout before boiling water for consumption.
- The first time you use the product you may notice the smell of plastic. This is normal and will gradually fade away.

1 Detach the Upper Lid and fill with water using another container.

- Do not fill over the Maximum Water Level Line.
(Hot water may overflow from the Steam Vent and Spout and cause scalding.)
- Do not fill the Inner Container directly from a water faucet or place the product on a wet surface such as a sink. (Water may get inside the Body and cause breakdown.)
- Do not pour water into the product through the Spout.
(Water may get inside the Body and cause breakdown.)

Wipe off any water droplets.

Maximum Water Level Line
▲MAX

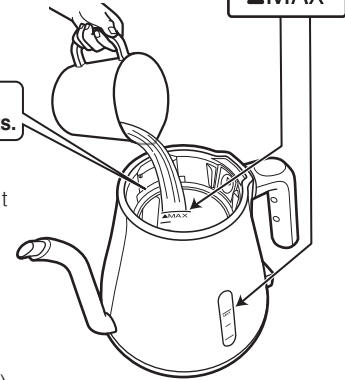

2 Attach the Upper Lid and place the Body on the Power Base.

- 1 Attach the Upper Lid.
- 2 Place the Body on the Power Base.

Set the Body on the Power Base correctly so that the Connector fits in the Receptacle securely. (The power cannot be turned on if not properly set.)

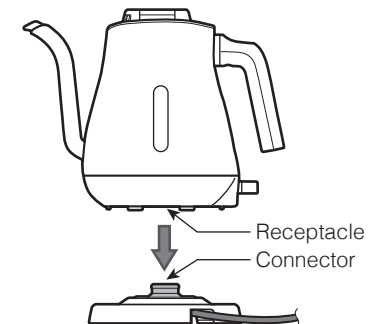

3 Begin boiling the water.

- 1 Make sure the Power Switch is switched OFF and insert the Power Plug into the electrical outlet.
- 2 Lower the Power Switch.

The Boil Light turns on and boiling starts.

- Make sure that the Upper Lid is completely attached.
(Otherwise the product may not switch OFF even when boiling has completed.)
- Please be aware that steam comes out of the Steam Vent and Spout.
- Take care to ensure the operation of the Power Switch is not hindered by parts such as the Power Cord.
(Failing to do so may prevent the power from turning off automatically, resulting in breakdown, water leakage, or scalding.)

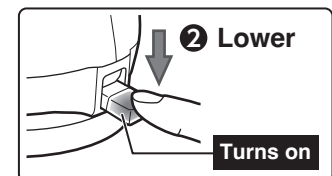
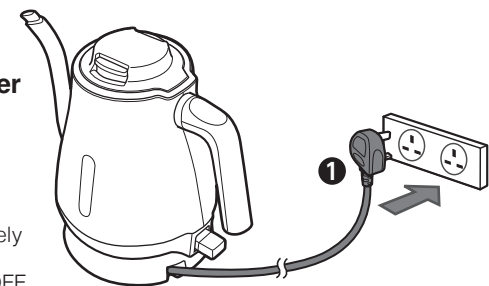

HOW TO USE (cont.)

4 When boiling has completed, the product automatically switches OFF.

The Boil Light turns off.

- Do not continue to press the Power Switch to force the water to continue boiling. (Doing so may result in steam accumulating inside the Body, resulting in breakdown, water leakage, or scalding.)
- To switch OFF the power before boiling has completed, raise the Power Switch with your finger to the OFF side.
- Do not detach or reattach the Upper Lid for a while after the water is finished boiling. (Hot water may splash out when pouring.)

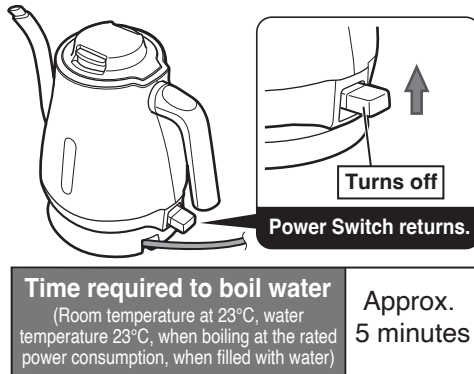

- This product is designed to turn OFF when steam is detected. Steam may make the area around the Power Switch foggy, become water droplets, and drip from the Bottom of the Body or under the Handle, but this is normal. This will also not result in breakdown, so you can use it without worry.
- There may be a click sound a while after using the product. This is the sound generated when the heated Sensor cools down, and this is normal. You can use it without worry.

5 Pour out the hot water.

- **Wait until boiling is finished before pouring.** (Failing to do so may result in hot water splashing or in scalding.)
- **Except when pouring, do not tilt the Body such as by tipping over or shaking it.**
- This product does not have a mechanism for locking the pouring of hot water. Hot water will be poured from the Spout as soon as the product is tilted, so handle the product carefully.
- Do not touch the steam that comes from the Spout or that escapes when the Upper Lid is opened.

1 Wait until boiling completes to remove the Body from the Power Base by holding the Handle.

2 Tilt the Body slowly to pour out the hot water.

- **Please follow the instructions below to reduce the risk of scalding:**
 - Check that the Upper Lid is securely closed before pouring hot water.
 - During use, the Steam Vent and Spout become hot, so do not touch them.
 - Avoid contact with the Lid Lock when pouring.

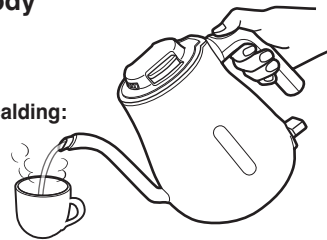

- **Do not tilt the Body suddenly.** (Doing so may result in hot water splashing or in scalding.)
- **Do not tilt the Body excessively. Also, only tilt the Body in the direction of the Spout.** (Hot water may leak from the Steam Vent or the bottom of the Body potentially causing scalding or electric shock.)

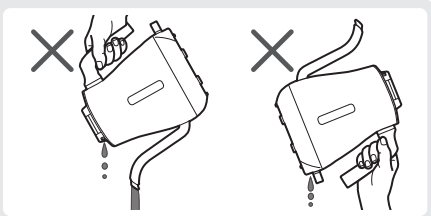

3 When you have finished pouring the hot water, return the Body to an upright position.

- Unplug the Power Plug from the electrical outlet after using the product.

6 Dispose of any unused water.

- Please be aware that hot water may drip from the inside of the Upper Lid when it is opened after use. (This may result in scalding.)

1 Detach the Upper Lid.

2 Hold the Handle and tilt the Body slowly to dispose of the remaining hot water from the direction of the Spout.

- Do not discard hot water from any direction other than that of the Spout. (Doing so may result in scalding. Hot water may get inside the Body and cause breakdown.)
- The Spout and Nozzle may become wet. This may pose a scalding hazard. Wipe the Spout and Nozzle dry if they are wet.
- Discard any unused water after each use, emptying the Inner Container completely. (Failure to do so may cause scale buildup or smells.)

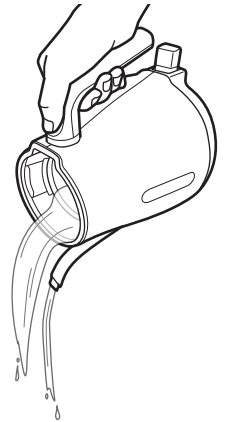

EMPTY BOILING DETECTOR

When the Power Switch is lowered while the Inner Container is empty, the Empty Boiling Detector is activated to prevent accidents due to overheating, and the product automatically switches OFF. (The Power Switch rises, and the Boil Light turns off.)

Remedy

Let the Inner Container cool down sufficiently before filling it with water and boiling water again.

CLEANING AND MAINTENANCE

Always unplug the Power Plug, dispose of all water, and allow the product to cool completely before cleaning.

- **Do not attempt to dry the product by turning it upside down when the Bottom is wet. (Water may get inside the body and cause it to break or rust.)**
- Do not use the following:
 - Thinner or bleach (Doing so may cause discoloration, cracks, degradation and corrosion.)
 - Polishing powder, brushes (including nylon brushes), anything made with metal, eraser pads, hard nylon sponges, and abrasive cleaners (Doing so may cause damage to the surface.)
 - Detergent (Hot water may spill out, resulting in scalding. Doing so may cause unwanted odor.)
- When using chemically treated cloths, do not rub too hard or leave them on the product for a long time as the surfaces of the product may be damaged by chemical reactions.
- Do not use a dishwasher or dish dryer for cleaning or drying. (Doing so may cause the plastic parts to deform or breakdown of the product.)
- Before storing the product for a long period of time, dry it completely and pack in a plastic bag to prevent odors from being absorbed.

CLEANING AND MAINTENANCE (cont.)

● Do not wash the Upper Lid, Body, or Power Base.
Do not splash water on the Power Switch, Receptacle, or Connector.
(Water will get inside and cause breakdown and rust.)

Upper Lid/Body/ Power Base	Wipe clean with a well-wrung soft cloth. <ul style="list-style-type: none">● Remove any foreign material that has affixed to the Steam Passage Hole.● Do not insert a cotton swab, wire, or similar object into the Steam Passage Hole or push such objects into this hole.
Inner Container/ Inside of the Spout	Perform Citric Acid Cleaning periodically →See below. Especially when... <ul style="list-style-type: none">● Red rust spots (Rust Stain) is visible on the Inner Container.● Milky white or black discoloration and/or filmy objects are found in the water.● Boiling is louder than usual.● Hot water has an odor. (The condition of the Inner Container will vary depending on the water quality and frequency of use.)
Receptacle/Connector/ Power Cord/Power Plug	Wipe clean with a soft dry cloth.

HOW TO PERFORM CITRIC ACID CLEANING

Do not drink the water used for citric acid cleaning.

In order to prevent gas bubbles and bubbling over, the Citric Acid Cleaner for Electric Water Boilers (CD-K03E-JU) is recommended for cleaning. (sold separately) (see pg. 13)
Perform Citric Acid Cleaning periodically (once every one to three months).

- 1 Put 30 g of citric acid in a cup and add warm water to dissolve. Pour it into the Inner Container and fill with water to the Maximum Water Level Line (▲MAX).

2 Attach the Upper Lid and connect the Power Plug.

3 Lower the Power Switch to boil the water and leave it for about 2 hours.

4 Detach the Upper Lid and discard the hot water.

5 Fill only with water, attach the Upper Lid, and boil the water.

6 Discard the hot water from the Spout.
(This is to rinse the Inner Container and the inside of the Spout.)
- Repeated citric acid cleaning might be necessary for hard-to-remove residues.

HOW TO REPLACE THE INNER LID GASKET

The Inner Lid Gasket may need to be replaced due to time and wear. Check it about once a year.

Wipe new Inner Lid Gaskets with a wet soft sponge before attaching to the Inner Lid.

When the Inner Lid Gasket hardens, changes shape, turns white, or otherwise becomes worn out.

Please purchase and replace with a new one.

If the Inner Lid Gasket hardens, changes shape, turns white, or otherwise becomes worn out, hot water may leak from the gap between the Upper Lid and Body when tilted or tipped over accidentally, resulting in scalding. Steam may also leak from the gap, causing scalding and product failures. If hot water spews from the gap or there is steam even after replacing the Inner Lid Gasket, other parts may be in need of repair. Make any inquiries to the retail store where you purchased this product.

To remove the Inner Lid Gasket

Hold the Upper Lid securely then remove the Inner Lid Gasket.

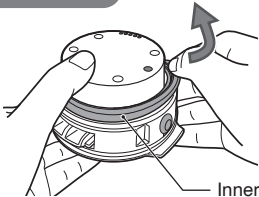

Inner Lid Gasket

- Do not remove any parts from the Upper Lid other than the Inner Lid Gasket. (Doing so may cause hot water to spill out, resulting in scalding.)
- Do not strongly pull the Inner Lid Gasket. (Doing so may cause damage.)

To attach the Inner Lid Gasket

1 Fit the Inner Lid Gasket to the outer circumference of the Upper Lid.

2 Press in all around the Inner Lid Gasket as illustrated to securely fit.

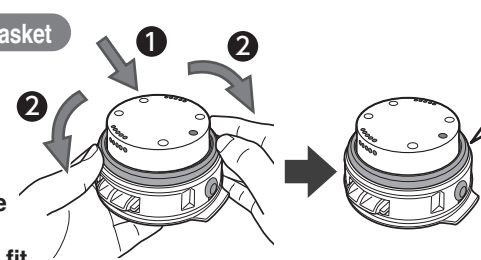

Cross-sectional drawing

Inner Lid Gasket

Orient the Inner Lid Gasket so the flat surface is on the bottom.

Be sure that the Inner Lid Gasket is securely fit.

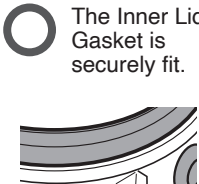

The Inner Lid Gasket is securely fit.

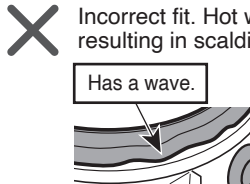

Incorrect fit. Hot water may leak from the gap created, resulting in scalding.

Has a wave.

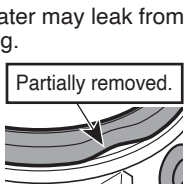

Partially removed.

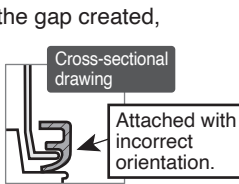

Cross-sectional drawing

Attached with incorrect orientation.

REPLACEMENT PARTS

- Replacement parts may be available for an additional charge. Please replace damaged parts only with new parts.
- When replacing parts, please record the model number and part name beforehand, then contact the retail store where you purchased this product.

Part Name	Part Number
Inner Lid Gasket	BF458016M-00
Citric Acid Cleaner for Electric Water Boilers (30 gx4 packets)	CD-K03E-JU

TROUBLESHOOTING GUIDE

Please check the following points before calling for service.

Condition	Cause	Remedy
The power does not turn on. The Boil Light does not turn on.	The Power Plug is not connected to an electrical outlet.	Connect the Power Plug.
	The Body is not set correctly on the Power Base.	Set it correctly.
	The Power Switch is not lowered.	Lower the Power Switch.
	Metal flakes or dust has accumulated on the Connector.	Remove any metal flakes or dust.
Boiling does not start. (The Power Switch returns to its original position.)	The Power Switch is lowered immediately after the water is finished boiling.	Let the Inner Container cool down sufficiently before filling it with water and boiling water again.
Even if the Power Switch is lowered, the power switches OFF after a while and the Boil Light turns off.	Water has not been added correctly. The Empty Boiling Detector has been activated.	
The water does not completely boil.	The Upper Lid is detached.	Securely attach the Upper Lid.
When water is poured in, it gets in the Steam Passage Hole.	<ul style="list-style-type: none"> Water inside the Steam Passage Hole exits from the bottom of the Body. Wipe away the water droplets before using the product. 	
Hot water pours out from the Steam Vent or Spout.	Check that the Inner Container is not filled over the Maximum Water Level Line.	Pour out the excess water until it is below the Maximum Water Level Line.
The area around the Power Switch becomes foggy.	<ul style="list-style-type: none"> This product is designed to turn OFF when steam is detected. Steam may cause the area around the Power Switch to become foggy, condensation on the Power Switch, or water droplets to drip from the Bottom of the Body or under the Handle, but this is normal. This will also not result in breakdown, so you can use it without worry. 	
Water droplets are dripping from the bottom of the Body or under the Handle.	Check that the Inner Container is not filled over the Maximum Water Level Line.	Pour out the excess water until it is below the Maximum Water Level Line.
	<ul style="list-style-type: none"> Are you lowering the Power Switch to force the water to continue boiling? Is the operation of the Power Switch hindered by parts such as the Power Cord? If you force boiling to continue, the outside of the Body may become hot or water droplets may drip from condensation inside the Body. Do not continue to lower the Power Switch. 	
	<ul style="list-style-type: none"> This product is designed to turn OFF when steam is detected. Steam may cause the area around the Power Switch to become foggy, condensation on the Power Switch, or water droplets to drip from the Bottom of the Body or under the Handle, but this is normal. This will also not result in breakdown, so you can use it without worry. 	

Condition	Cause	Remedy
A filmy, floating residue is noticeable.	Residue is due to the content (minerals or iron) in water, not from corrosion of the Inner Container.	Perform citric acid cleaning. (see pg. 12) <div> Scale Over time and use, calcium and other minerals contained in water build up on the surface of the Inner Container. It is called "scale" and is harmless to your health. </div>
A milky white and rough-surfaced substance, or red or gray rust-like spotting has formed on the surface of the Inner Container.		
Boiling is louder than usual.	When accumulated scale is left on the surface of the Inner Container, boiling may become louder than usual.	
There is a light sound coming from the Upper Lid.	<ul style="list-style-type: none"> This sound is normal and comes from the movement of the weight that prevents hot water from overflowing when the product is overturned. 	
There is a click a while after the water is finished boiling.	<ul style="list-style-type: none"> The sound is generated when the heated Sensor cools down, and this is normal. 	
The outside of the Body becomes very hot.	<ul style="list-style-type: none"> Are you lowering the Power Switch to force the water to continue boiling? Is the operation of the Power Switch hindered by parts such as the Power Cord? If you force boiling to continue, the outside of the Body may become hot or water droplets may drip from condensation inside the Body. Do not continue to lower the Power Switch. 	
The outside of the Body becomes hot.	<ul style="list-style-type: none"> When the water temperature and/or room temperature is high, the outer surface of the Body may reach up to 60°C. This is not a malfunction. 	
The Power Cord becomes hot.	<ul style="list-style-type: none"> The Power Cord may become hot while the water is boiling. This is not a malfunction. 	
Replacement for the Upper Lid	Inner Lid Gasket	<ul style="list-style-type: none"> The Inner Lid Gasket is expendable, and we recommend that you replace it about once a year. If steam leaks from the gap between the Upper Lid and the Body, or if the Inner Lid Gasket hardens, changes shape, turns white, or otherwise becomes worn out, please replace it. (see pg. 13)
	Plastic Parts	<ul style="list-style-type: none"> The plastic part of the Upper Lid may deteriorate over time. If discoloration occurs or the surface becomes coarse, replace the Upper Lid (additional charge required). (We take care in only using materials for the plastic parts that are safe and hygienic for food contact.)

規格

型 號	CK-LAQ08
額 定 容 量	0.8L
額定電壓及額定頻率	交流220-230V 50/60Hz
總額定消耗電功率	1006-1100W
電 源 線 長 度	0.7m
外 形 尺 寸 (約cm)	寬28×深16×高21 (不含電源座)
	寬28×深16×高23
重 量	約1.0kg (不含電源座)
	約1.3kg

- 在特定區域（高山，嚴寒地等）時，功能可能無法正常運作，請避免在這些區域使用。
- 本產品不能在電源電壓或電源頻率相異的地區使用。

如何更換保險絲

1. 打開電源插頭的保險絲蓋。
2. 拆下內部保險絲。
3. 在保險絲蓋上安裝新保險絲，保險絲蓋裝回到電源插頭上。
(請務必更換與安裝的保險絲具有相同電流值的保險絲。)

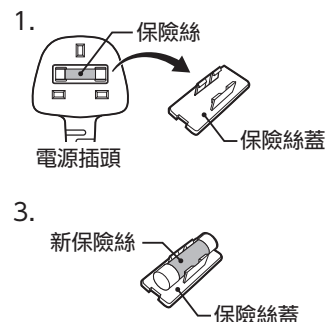

HKG

SGP

快速電熱水壺

使用說明書

CK-LAQ08

- 感謝您購買本產品。
- 請在使用前詳讀使用說明書，以便正確使用，並請妥善保管本說明書。

目錄

使用前

安全注意事項.....	2
各部位名稱和使用方法.....	6

困惑時

認為故障時.....	14
規格.....	16

使用方法

使用方法.....	9
關於防止空燒.....	11

清理

清理.....	11
檸檬酸清洗方法.....	12
更換內蓋墊圈.....	13
關於零件更換、購買.....	13

- 本產品為燒水專用，不具備保溫功能。
- 本產品不具有注水鎖定結構。

ZOJIRUSHI CORPORATION
OSAKA, JAPAN



安全注意事項

務請遵守

為了防止給使用者或他人帶來危害及財產損害，特此說明務請遵守事項。

■將因錯誤操作而導致的危險及損害程度，按以下區分說明。



警告

表示如果操作有誤，可能會導致死亡或重傷的內容。



注意

表示如果操作有誤，可能會導致輕傷或房屋、財產等損害的內容。

■務請遵守的內容，按以下的區分予以說明。



不得進行的「禁止」內容。



務必實行的「指示」內容。



警告



請勿改造。除了本公司技術人員以外，請勿拆卸、修理。

否則，有火災、觸電、受傷之危險。
需修理（內蓋墊圈（消耗品）的更換除外）時，請洽詢購買店。

請勿浸水或濺水。

請勿放在洗碗槽的台上等潮濕的地方。

否則，會有短路、觸電之危險。

請勿用濕的手插拔電源插頭。

否則，有可能會導致觸電或受傷。

請勿讓本體連接部和電源座沾濕，或浸泡於液體中。

否則，會有短路、觸電之危險。

本體連接部、電源座連接部（金屬部分）請勿吸附金屬物或灰塵等。

否則，會導致觸電、短路、著火。

請勿將本體連接部、電源座連接部（金屬部分）放入口中。

否則，會導致觸電、受傷。
特別是應注意請勿讓嬰幼兒放入口中。

請勿讓嬰幼兒單獨使用，請勿放在嬰幼兒摸得到的地方。

否則，會有燙傷、受傷、觸電之危險。

請勿使用交流220-230伏特以外的電源。

否則，會導致火災、觸電。

電源線或電源插頭有損傷或電源插座鬆動時，請勿使用。

否則，會導致觸電、短路、著火。



電源線請勿受損。

電源線請勿割傷、損壞、過度彎曲、拉扯、扭轉、打結、或靠近高溫處。並請勿壓上重物、擠壓、或重新自行組裝。否則，電源線損傷，會導致火災、觸電。

請勿放置於火源（如瓦斯爐等）、電暖器、電磁爐等上方。

否則，會導致火災、故障。

請勿觸摸蒸氣口、出水口，勿將手、臉靠近。

否則，會導致燙傷。
尤其應注意請勿讓嬰幼兒觸摸。

請勿用抹布等東西覆蓋在蒸氣口、出水口上。

否則，熱水溢出，會導致燙傷。
也可能會導致上蓋的變形、變色及故障。



警告



請勿用力關閉上蓋。

否則，熱水溢出，會導致燙傷。

請勿翻倒產品。

否則，熱水流出，會導致燙傷。
本產品不具有注水鎖定結構。
即便上蓋處於閉合狀態，視翻倒時的情況，仍存在熱水從出水口等流出的風險。

注水時請勿過度傾斜本體，或是向出水口以外的方向傾斜。

否則，會導致熱水從蒸氣口、本體底部漏出，引起燙傷、觸電。

移動或倒水時，請勿抱產品或使其傾斜、晃動或手持上蓋。

否則，熱水流出，會導致燙傷。
本產品不具有注水鎖定結構。傾斜時，熱水將從出水口流出，使用時請務必小心。

請勿放入冰塊作為保冷使用。

否則會有結露現象，會導致觸電或發生故障。

裝水請勿超過滿水標示。

否則，熱水溢出，會導致燙傷。
此外，可能導致出水口、本體底部或手柄處有水滴滴下。



請勿放入或煮水以外的東西。

否則，可能生成氣泡、或因內容物溢出導致燙傷，還會導致注水管路堵塞，內容器燒焦、腐蝕。

- 牛奶、酒、湯、備長炭、茶包、茶葉、咖啡粉、速溶咖啡
- 烹調速食食品
- 加熱調理包食品或將食材放入塑膠袋中加熱烹調
- 商店出售的水質改良物（碳等）及礦物質添加物



需單獨使用額定10安培以上的電源插座。

若與其他器具共同使用，多孔插座會因出現異常發熱現象，導致著火。

務必把電源插頭完全插入插座。

否則，會導致觸電、短路、冒煙、著火。

電源插頭及其前端有灰塵附著時，應仔細擦拭。

否則，會導致火災。

務請確實安裝上蓋。

否則，翻倒時熱水流出，會導致燙傷。

發生異常及故障時，請立即停止使用。

如果照常使用會導致冒煙、著火、觸電、受傷的危險。

〈異常、故障例〉

- 電源插頭、電源線異常發熱
- 電源線損傷，觸碰導致通電斷續
- 產品變形或異常發熱
- 產品冒煙，有焦臭味
- 產品的部分破損、鬆動或晃動
- 蒸氣持續從蒸氣口、出水口冒出5分鐘以上
- 水從產品漏出

發生以上現象時，請立即拔下電源插頭，並洽詢購買店。

安全注意事項 續

警告



內蓋墊圈有變硬、萎縮或顏色變白等老化情形時請更換。

否則，傾斜或不慎翻倒時，熱水流會導致燙傷。
蒸氣洩漏可能造成燙傷、故障。

在沒有成年人或監護人等對本機器的使用給予指揮管理或指示的情況下，本身對於運動能力、感覺能力或是智力低下及缺乏經驗和知識的人（包括兒童）嚴禁使用本機器。
請確保兒童不使用及碰觸本機器。

注意



燒水時，請勿移動或注水。

否則，熱水濺出，會導致燙傷。

沸騰中或沸騰後過一段時間，請勿打開上蓋。

否則，會導致燙傷。

使用中或使用後，暫時避免觸摸高溫部位（本體連接部等）。

否則，會導致燙傷。

搬運產品時，不可碰觸上蓋開閉鈕。

否則，上蓋脫落會導致燙傷、受傷。

請勿對壺嘴施加過大的力。

否則，會導致故障、破損。

出水口前端變形時，請勿使用。

否則，熱水濺出，會導致燙傷。

拆卸上蓋時，請勿碰觸冒出的蒸氣。

否則，會導致燙傷。

倒掉熱水時，請勿接觸蒸氣。

否則，會導致燙傷。

請勿空燒。

否則，會導致火災、故障。

請勿放在不穩定的地方使用。

否則，會導致燙傷、受傷。

請勿在熱源附近使用。

否則，會導致火災、故障。

請勿放在不耐熱的墊子或桌面上使用。

否則，會導致火災。

請勿在距離牆壁或傢俱過近之處使用。

否則，蒸氣或散熱會導致牆壁或傢俱損傷、變色或變形。

請勿在其他電器上使用。

發生漏水時，會導致電器火災、故障。

請勿在蒸氣會噴到其他電器的地方使用。

否則，蒸氣噴出會導致電器火災、故障、變色及變形。

必須使用專用電源座。

該專用電源座請勿用於其他電器，或國外規格的電器產品。

否則，會導致故障或著火。

注意



請待本體冷卻後再進行清理。

否則，碰觸到高溫部位會導致燙傷。

繼續使用時，待上蓋及本體冷卻後再燒水。

否則，會導致燙傷。

不使用時，請將電源插頭拔離插座。

否則，會導致燙傷、受傷，或因電源線材絕緣劣化導致觸電、漏電、火災。

請待沸騰停止過後，再倒出熱水。

否則，熱水濺出，會導致燙傷。

拔下電源插頭時，務必手持插頭，請勿拉扯電源線。

否則，會導致觸電、短路、著火。

若電源線損壞時，請勿繼續使用，並請洽詢購買店，由專業人員更換特別電源線（自費）以避免危險。

敬請注意

■長時間放置不使用時，請務必拔下電源插頭並將內容器的水完全倒淨。

否則，會導致故障。

■放置於廚房用收藏架等處使用時，注意不要讓蒸氣碰到上層架板或天花板。

否則，會導致變色或變形。

■請注意避免讓水潑到電源開關。

否則，會導致故障。



■加水時、拆卸或安裝上蓋時，在將本體從電源座上取下的狀態下實施。

否則，可能將水灑到電源座上，導致故障。

■請避免掉落、碰撞等撞擊。

否則，會導致故障、破損。

■請勿用力重放或牽拉本體及電源座移動。

否則，會導致刮傷桌面等。

■請將內容器邊緣殘留的水滴擦拭乾淨後，再裝上蓋。

否則，倒熱水時會導致水由上蓋和本體之間滴流。



■請勿持續按下電源開關強制連續燒水。

否則，本體內部會累積蒸氣導致故障、漏水、燙傷。

■請注意避免電源線妨礙電源開關的動作。

否則，電源線等卡住，電源無法自動切斷，本體內部會累積蒸氣導致故障、漏水、燙傷。

■本產品適用於一般家庭以及下列類似用途。

- 可用於商店、辦公室或其他工作環境中之員工用廚房。
 - 可用於住宅的起居室或與廚房類似的環境中。
- ※但請勿在不特定人數多的情況下長時間使用。

注意

從包裝箱取出本產品時，上蓋和內容器可能會留有些許水滴。這是因為進行煮水測試等檢查的關係。
第一次使用時，請先將水煮開並倒掉之後，再開始使用。

各部位名稱和使用方法

- 本產品的本體與電源座為分離式設計。
- 本產品不具有注水鎖定結構。傾斜時，熱水將從出水口流出，使用時請務必小心。

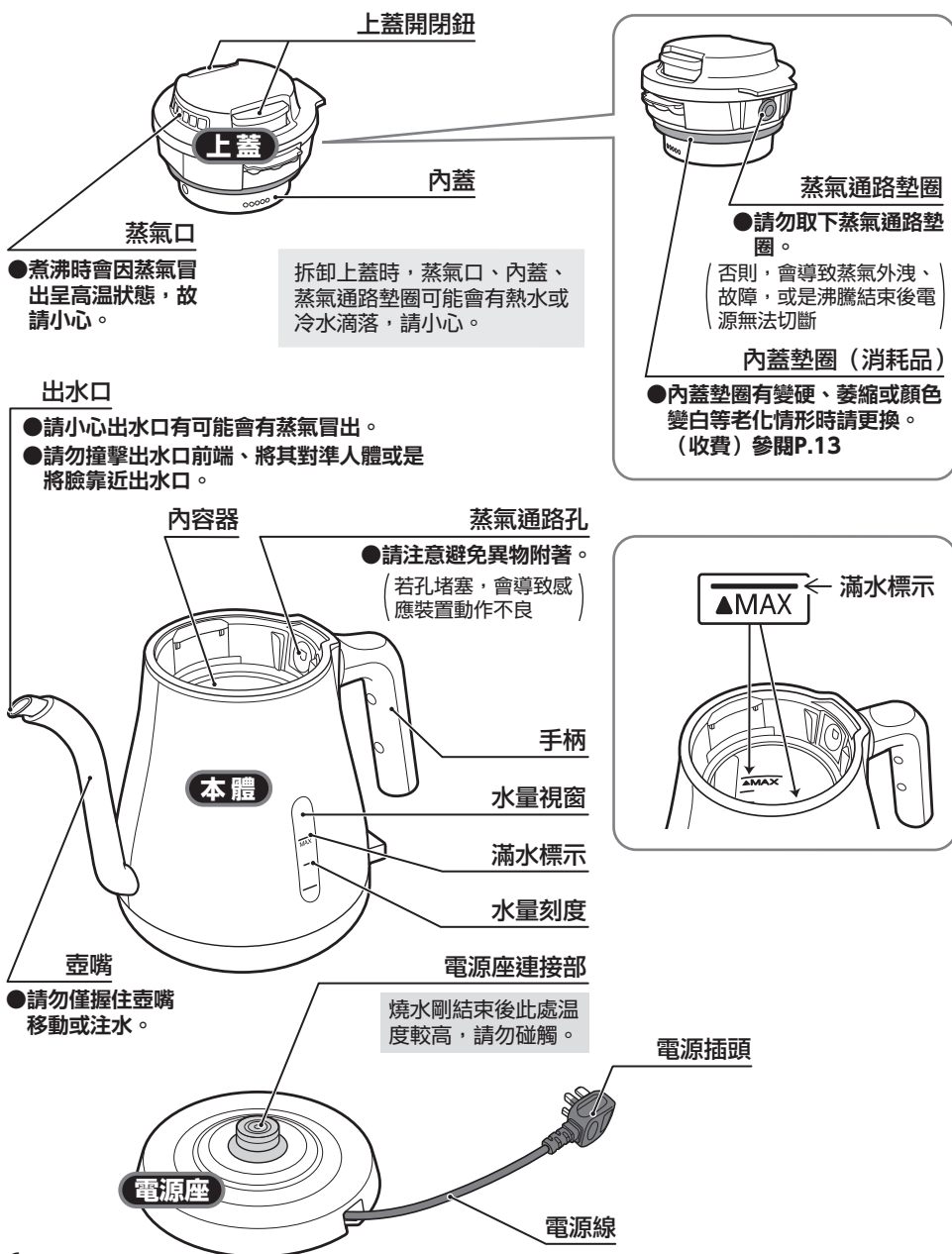

操作部

向下按電源開關將會開啟電源，沸騰燈會亮燈。

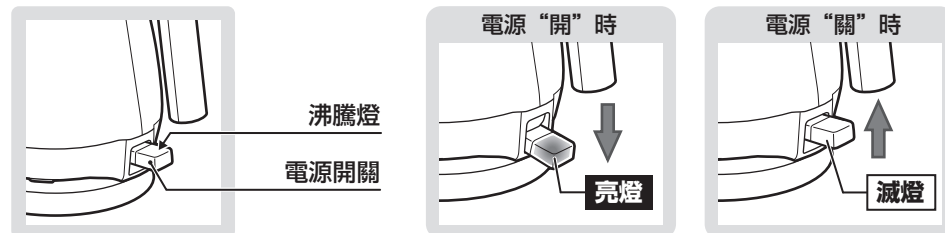

本體底部

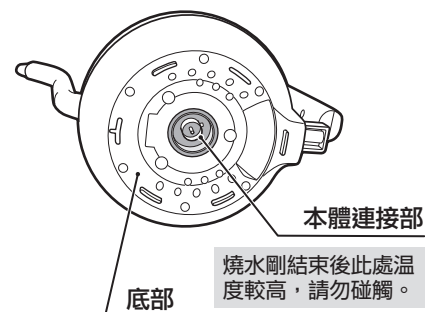

電源座底部

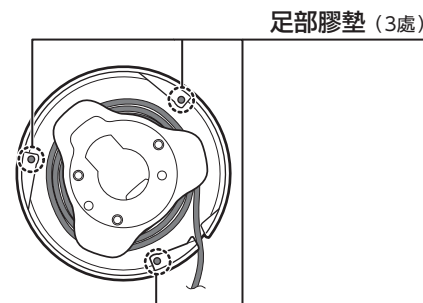

調節電源線的長短

請將電源線繞於電源座的底部 (順時針方向) 來調節長度，並通過電源座上的缺口處將電源線拉出。

電源座底部

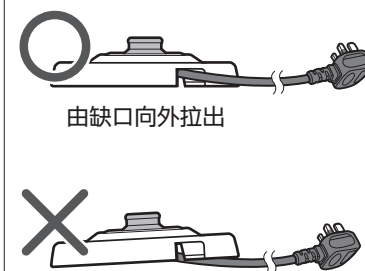
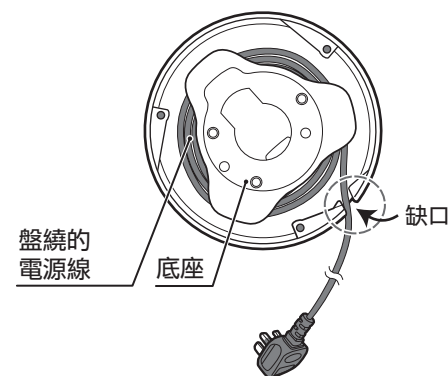

- 請勿將電源座放置於電源線上。

否則，會導致傾倒
若於上方放置重物或夾壓到電源線時，
可能會導致電源線損壞，而導致火災、
觸電

各部位名稱和使用方法 續

上蓋的拆卸和安裝方法

請注意避免產品翻倒。

●萬一產品翻倒時

- 立起產品時請勿將手等靠近蒸氣口、出水口。
(否則, 蒸氣口、出水口可能有熱水或蒸氣冒出, 導致燙傷)
- 立起產品後, 拆卸上蓋, 傾斜上蓋將內部累積的熱水倒掉。
(否則, 熱水可能累積於上蓋內部, 會導致燙傷)



拆卸方法

- ①捏住上蓋開閉鈕的凹處
- ②捏著往上拉提, 拆卸上蓋

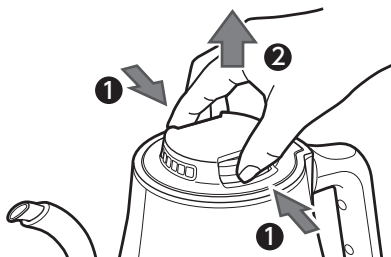

- 上蓋內部累積的熱水或冷水可能從蒸氣口、內蓋、蒸氣通路墊圈滴落。
拆卸上蓋時, 請注意避免上蓋內部的水滴落到手上。

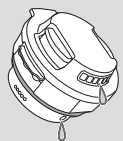

安裝方法

- ①安裝時將上蓋的凸處對準本體手柄的凹處

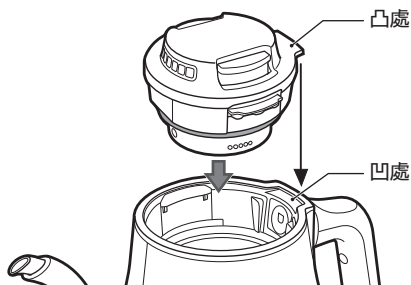

- ②確實按壓上蓋直至聽到“喀嚓”聲為止



●請確認上蓋已完全安裝完成。

若上蓋有傾斜, 或可看見記號A或記號B, 表示上蓋未完全安裝完成。
請確實按壓上蓋直至看不見記號(A和B)為止。

如果照常使用, 會導致熱水漏出引起燙傷。
沸騰結束後電源可能無法切斷, 從而導致故障。

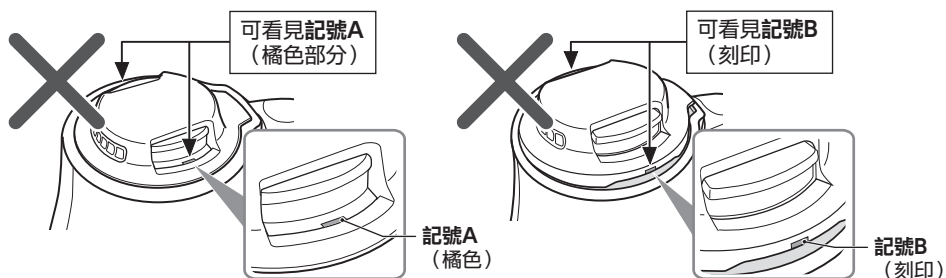

使用方法

- 初次使用或長時間未使用時, 請將水煮沸倒掉後, 再進行使用。
- 剛開始使用時可能有塑膠等異味, 經使用後會逐漸消失。

1 拆卸上蓋, 使用別的容器加入水

- 加水時, 請勿超過滿水標示。
(否則, 會導致熱水從蒸氣口、出水口溢出而燙傷)
- 請不要從水龍頭直接加水, 也不要放置於水槽內將底部弄濕。
(否則, 本體內部進水會導致故障)
- 請不要從出水口加水。
(否則, 本體內部進水會導致故障)

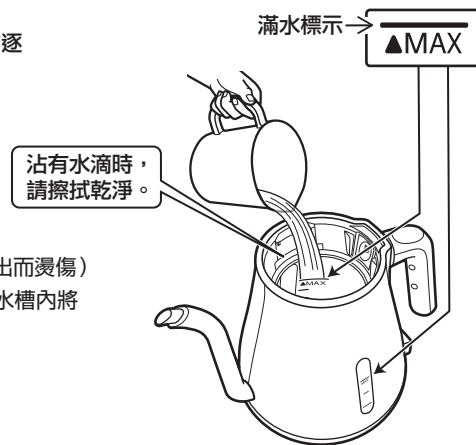

2 安裝上蓋 將本體置於電源座上

- ①安裝上蓋
- ②將本體置於電源座上

請將本體連接部與電源座連接部確實對好。
(如未對正放置, 就不會開始燒水。)



3 開始燒水

- ①確認電源開關為“關”的狀態, 將電源插頭完全插入電源插座
- ②按下電源開關

沸騰燈亮燈, 開始燒水。

- 請確認上蓋已完全安裝完成。
(否則, 會導致沸騰結束後無法切斷電源)
- 蒸氣口、出水口有可能會有蒸氣冒出, 請小心。
- 請注意避免電源線妨礙電源開關的動作。
(否則, 電源無法自動切斷, 會導致故障、) 漏水、燙傷

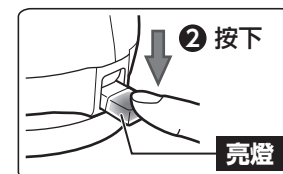
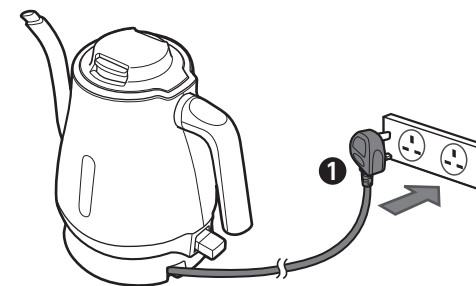

使用方法 續

4 水沸騰後 電源會自動切斷

沸騰燈滅燈。

- 請勿持續按下電源開關強制連續燒水。
(否則, 本體內部會累積蒸氣導致故障、
漏水、燙傷)
- 若要在沸騰完成前切斷電源, 請用手指將
電源開關向上推至「關閉」位置。
- 沸騰結束後一段時間, 請勿拆卸上蓋或重
裝。
(否則, 會導致注水時熱水飛濺)



- 本產品為感應蒸氣以自動切斷電源的設計。此蒸氣可能使電源開關周圍籠罩霧氣, 蒸氣化為水滴
從本體底部或手柄下滴落, 但並非故障。此外, 這也不會造成故障, 故請安心使用。
- 使用後過一段時間, 會發出「喀喀」的聲音, 這是被加熱的沸騰感應裝置冷卻時所發出的聲音,
產品並無問題。請安心使用。

5 注水

- 請待沸騰停止過後, 再倒出熱水。(否則, 熱水濺出, 會導致燙傷)
- 請勿在注水以外時傾斜本體, 例如翻倒、搖晃本體等。
- 本產品不具有注水鎖定結構。傾斜時, 熱水將從出水口流出, 使用時
請務必小心。
- 請勿接觸從出水口冒出的蒸氣或是打開上蓋時冒出的蒸氣。

①待沸騰停止過後 握住手柄, 將本體從電源座上取下

②慢慢傾斜倒出熱水

- 請遵守以下事項, 否則可能會導致燙傷。
 - 請先確認上蓋切實關閉, 再倒出熱水。
 - 使用中, 蒸氣口、出水口處於高溫狀態, 請勿觸摸。
 - 注水時請勿碰觸上蓋開閉鈕。

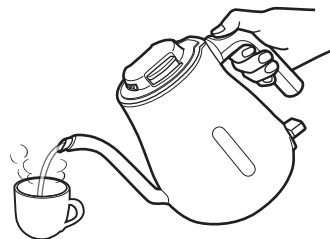

- 請勿快速傾斜。
(否則, 熱水濺出, 會導致燙傷)
- 請勿過度傾斜本體, 或是向出水口
以外的方向傾斜。
(否則, 熱水會從蒸氣口、本體
底部漏出, 導致燙傷或觸電)

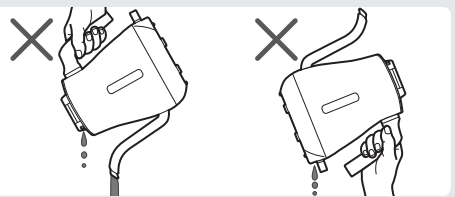

③注水結束後將本體返回水平狀態

- 不使用時, 應從電源插座上拔下電源插頭。

6 倒掉剩餘熱水時

- 使用後, 打開上蓋時, 可能有熱水從
上蓋內部滴落, 請小心。
(否則, 會導致燙傷)

①拆卸上蓋

②握著手柄, 慢慢傾斜, 從出水口方向 將剩餘熱水倒掉

- 請勿從出水口以外的方向倒掉熱水。
(否則, 會導致燙傷
熱水可能進入本體內部導致故障)
- 出水口和壺嘴可能沾水。
注意避免燙傷。
沾水時, 請擦拭乾淨。
- 使用後, 請勿殘留熱水, 將內容器中的水倒空。
(否則, 會導致水垢附著、有異味)

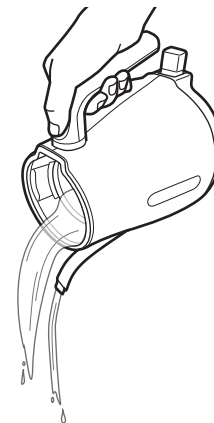

關於防止空燒

若於內容器空的狀態下按下電源開關,
為了防止因過熱發生事故, 防止空燒功
能會啟動, 使電源自動切斷。
(電源開關抬起, 沸騰燈滅燈。)

處理

待內容器充分冷卻後加入水,
再次燒水。

清理

清洗產品前請務必從電源插座上拔下電源插頭, 倒淨剩餘熱水並待產品冷卻。

- 請不要在底部潮濕的狀態下將產品倒置進行晾乾。
(一旦內部進水會導致故障或生銹)
- 請勿使用以下物品。
 - 稀釋劑、漂白劑等(否則, 會導致變色、破裂、退化、腐蝕)
 - 去污粉、尼龍刷、金屬製的東西、科技海綿、尼龍海綿、刷子、含有研磨劑的洗潔劑等
(否則, 會導致表面受損)
 - 洗潔劑(否則, 熱水溢出, 會導致燙傷、有異味)
- 使用化學抹布時, 請勿大力搓刷或長時間放置。
(否則, 會導致表面受損或引起化學反應)
- 請勿使用烘碗機或洗碗機。
(否則, 會導致樹脂變形、故障)
- 長時間不使用時, 為避免留有異味, 請將本體及上蓋充分晾乾後放入塑膠袋內保管。

清理 續

●請勿整體沖洗上蓋、本體、電源座。此外，請勿讓水潑濺到電源開關、本體連接部、電源座連接部。（否則，一旦內部進水會導致故障或生銹）

上蓋、本體、電源座	用擰乾水分的濕抹布擦拭。 <ul style="list-style-type: none">●蒸氣通路孔上有異物附著時，請去除。●請勿將棉棒或金屬針等伸入或塞入蒸氣通路孔。
內容器、出水口內部	定期進行檸檬酸清洗。請參閱以下說明 出現以下情況時，請進行檸檬酸清洗。 <ul style="list-style-type: none">●紅色銹斑（氧化鐵）●乳白色、黑色等的變色，及薄膜狀浮游物●燒水時聲音過大●熱水有異味 （內容器的污垢程度會根據當地的水質和燒水次數而不同。）
本體連接部、電源座連接部、電源線、電源插頭	用乾軟布擦拭。

檸檬酸清洗方法

不要飲用檸檬酸洗淨中的熱水。

為了防止起泡和溢出，請使用本公司的熱水瓶內容器清洗用檸檬酸（CD-K03E-JU、另售）。

參閱P.13

請定期（1~3個月1次）進行檸檬酸清洗。

- 1 將檸檬酸30g放入杯中，用溫水溶化開，然後在內容器中加水並倒入檸檬酸液體（水量不要超過滿水標示 ▲MAX ）
- 2 安裝上蓋並插上電源插頭
- 3 按下電源開關燒水，此狀態下靜置約2小時
- 4 拆卸上蓋的狀態倒掉熱水
- 5 只加入水後安裝上蓋，燒水
- 6 由出水口倒掉熱水
（為沖洗內容器及出水口內部）

●污垢難以去除時，請反覆使用檸檬酸洗淨。

更換內蓋墊圈

內蓋墊圈是消耗品，建議1年更換1次。

新內蓋墊圈，請先用濕的軟海綿擦拭後再安裝。

內蓋墊圈有變硬、萎縮或顏色變白等老化情形時...

請更換新的內蓋墊圈（收費）

當內蓋墊圈有變硬、萎縮或顏色變白等老化情形時，如果傾斜或不慎翻倒，熱水有可能從上蓋與本體之間流出，有燙傷的危險。蒸氣洩漏可能造成燙傷、故障。
若更換內蓋墊圈後還是蒸氣洩漏或熱水溢出時，可能還有其他零件損壞，請洽詢購買店。

內蓋墊圈的拆卸方法

拿緊上蓋，
拆下內蓋墊圈

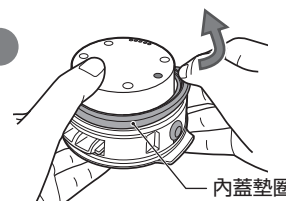

- 請勿由上蓋取下內蓋墊圈以外的任何零件。
（否則，會導致熱水溢出而燙傷）
- 請勿用力拉扯內蓋墊圈。
（否則，會導致破損）

內蓋墊圈的安裝方法

① 將內蓋墊圈套入上蓋外周

② 如圖所示，再將內蓋墊圈全部嵌入

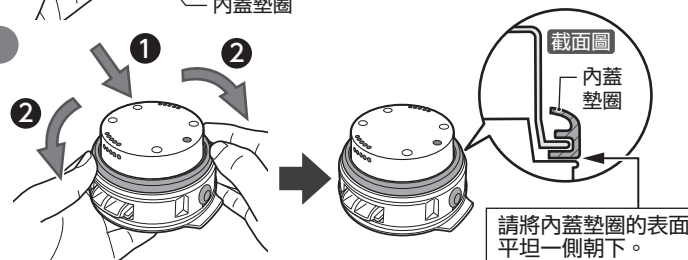

請將內蓋墊圈的表面平坦一側朝下。

請確認內蓋墊圈是否已完全套進。

○ 正確裝入狀態



✗

熱水會從間隙流出導致燙傷。

呈波浪狀



呈脫離狀



截面圖



上下顛倒

關於零件更換、購買

●右表為更換零件的名稱。損壞時，請更換新的零件（收費）。

●更換時，請確認好產品的型號及零件名稱後，請到購買店購買。

零件名稱	零件號碼
內蓋墊圈	BF458016M-00
熱水瓶內容器清洗用檸檬酸（30g×4包裝）	CD-K03E-JU

認為故障時

委託修理前，請檢查以下項目。

現象	原因	處理方法
未通電 沸騰燈不亮	電源插頭是否脫落？	插入電源插頭。
	本體是否正確地放置在電源座上？	請正確放置。
	是否有按下電源開關？	請按下電源開關。
	電源座連接部是否沾附金屬片或垃圾？	請取下沾附於其上的金屬片或垃圾。
無法開始燒水 （電源開關自動切斷）	是否燒水剛結束後就按下電源開關？	待內容器充分冷卻後加入水，再次燒水。
按下電源開關後，不久電源自動切斷，沸騰燈滅燈	是否已加入水？ 有可能防止空燒功能啟動中。	
無法完成沸騰	上蓋是否未蓋好？	請確實安裝上蓋。
加水時，水進入了蒸氣通路孔	●進入蒸氣通路孔的水從本體底部流出。 請先擦拭掉水滴再使用。	
熱水從蒸氣口、出水口自動流出	加水超過滿水標示以上。	水量保持在滿水標示以下。
電源開關周圍籠罩霧氣	●本產品為感應蒸氣以自動切斷電源的設計。 蒸氣可能使電源開關周圍籠罩霧氣、電源開關上冷凝水滴或是本體底部或手柄處有水滴落下，但並非故障。此外，這也不會造成故障，故請安心使用。	
本體底部或手柄處有水滴落下	加水超過滿水標示以上。	水量保持在滿水標示以下。
	●是否持續按下電源開關強制連續燒水？ 電源線是否妨礙電源開關的動作？ 強制持續燒水會使本體外側變熱，或在本體內部凝結成水滴而滴流。 請勿連續按電源開關。	
	●本產品為感應蒸氣以自動切斷電源的設計。 蒸氣可能使電源開關周圍籠罩霧氣、電源開關上冷凝水滴或是本體底部或手柄處有水滴落下，但並非故障。此外，這也不會造成故障，故請安心使用。	

現象	原因	處理方法
熱水中有薄膜狀的白色浮游物	這是水質成分（礦物質、鐵質成分）所致，並非內容器的腐蝕。	<div>請用檸檬酸洗淨內容器。 參閱P.12</div> <div>水垢</div> <div>在使用過程中，水質成分（礦物質）會附著在內容器上，這就是通常所說的“水垢”，並非有害物質。</div>
內容器附著乳白色粗糙物、紅色銹斑或灰色斑點		
燒水時，聲音越來越大		
上蓋發出“喀搭喀搭”的聲音	●這是萬一產品傾倒時，為防止熱水流出所設置的鋼珠球滾動的聲音，並非異常。	
沸騰後過一段時間，會發出“喀嚓”的聲音	●這是被加熱的沸騰感應裝置冷卻時所發出的聲音，並非異常。	
本體外側異常變熱	●是否持續按下電源開關強制連續燒水？ 電源線是否妨礙電源開關的動作？ 強制持續燒水會使本體外側變熱，或在本體內部凝結成水滴而滴流。 請勿連續按電源開關。	
本體外側變熱	●水温或室溫較高時，本體的外表會達到約60℃。並非異常。	
電源線發熱	●煮沸過程中，有時電源線可能會發熱，並非異常。	
上蓋的消耗	內蓋墊圈	●內蓋墊圈是消耗品，建議1年更換1次。如果從上蓋與本體的間隙處冒出蒸氣、內容器上緣有殘留水珠、或內蓋墊圈有變硬、萎縮、顏色變白等老化情形時，請更換新的墊圈。參閱P.13
	樹脂零件	●上蓋的樹脂零件，會隨使用而產生損傷。因使用符合食品衛生安全的材質，當樹脂零件變色或變的粗糙時，請更換新的上蓋（收費）。